



NORANDEX HOUSEWRAP will assure you are protecting your customer's home with a superior weather resistant barrier. Just one small way Norandex is putting your needs first.

Norandex Housewrap can be imprinted with business logo for maximum advertising exposure!!



Keeps water out - Reduces drafts
Improves efficiency of insulation - Cuts energy bills
Allows interior moisture to escape - Helps prevent mold, mildew & rot

Housewrap is the “best practice” for protecting a home from wind and water while allowing it to breathe. Norandex makes it easy!

- Stronger than ever, our wrap can be installed with staples. No need for expensive cap nails
- Perm rating is appropriate for all climates
- Not affected by surfactants, such as soaps, cleaning agents, detergents
- Can be used under all types of products (e.g. vinyl siding, stucco, wood, steel, brick, stone and fiber cement)
- Features 9-month protection from ultraviolet degradation
- Lightweight and easy to cut
- Translucent so you can see through the wrap where to staple or nail
- Standard Norandex product is shipped within 5 days or less (NOT applicable to custom imprint orders)
- Micro-perforated to allow waterborne vapor to permeate out through the wrap and into the atmosphere
- Improves efficiency of wall insulation and seals cracks and seams in walls to reduce drafts for a more comfortable home
- Woven, polypropylene wrap is both tough and tear resistant
- Will not support mold growth
- Meets or exceeds standards for all code approvals
- Easy to order
- Custom imprinting program available with customer logo (one pallet minimum)
- Custom imprint orders will arrive within 14 days of receipt of order

NORANDEX HOUSEWRAP SPECIFICATIONS

	Product Specification	Test Method
Composition	Woven Polypropylene	
Weight Per Roll	11.8 lbs./MSF	
Thickness	5.5 mils	
Tensile Strength		ASTM D-882
Machine Direction	45.17	
Cross Direction	50.77	
Tear Strength		ASTM D-5034
Machine Direction	34.13	
Cross Direction	36.53	
Water Resistance	Pass	ASTM D-1709
MVTR/Perms	8 Perms	ASTM E-96
Fire Rating	Class A	ASTM E-94

Roll Size	Rolls per Pallet
9 ft x 100 ft	50
9 ft x 150 ft	45
9 ft x 195 ft	40
10 ft x 100 ft	50
10 ft x 150 ft	45
10 ft x 195 ft	40
4.5 ft x 100 ft	100



SEAMING TAPE

Order in case qty (12 tape rolls/case)
size: 3" x 110 yards

Freight prepaid on tape when ordered with a pallet of housewrap

Norandex Housewrap meets all national code requirements and can be used under all types of siding and masonry cladding materials. (Vinyl siding, stucco, wood, steel, brick, stone and fiber cement).

Meets the latest ICC Code requirements for water resistive barrier as well as new air barrier requirement with an air leakage rate of less than 0.02 L/S/m² per ASTM 2178-03 in accordance with ICC AS-38.

Custom Imprinting Available!

Put your name right in the center of every wall you cover with our custom-imprinting program. Order your personalized house wrap one pallet at a time with no plate charges or additional printing fees. Order will arrive within 14 days of factory receipt of order.

Minimum Quantity:	One Pallet
Additional Charge:	None
Plate Charge:	None (Up to 500 square inches max)
1 or 2 colors Logo:	Standard colors at no additional charge

(Customization N/A on 3' x 150')

RED PMS 186	PURPLE PMS 274	GREEN PMS 382
RED PMS 202	BLUE PMS 280	BROWN PMS 4635
BURGUNDY PMS 492	BLUE PMS 287	BROWN PMS 464
ORANGE PMS 485	BLUE PMS 293	BLACK
ORANGE PMS 172	GREEN PMS 357	GRAY PMS 425
ORANGE PMS 151	GREEN PMS 342	GRAY PMS 430
YELLOW PANTONE C	GREEN PMS 361	Standard Colors Available
YELLOW PMS 141	GREEN PMS 376	



NORANDEX PLUS HOUSEWRAP SPECIFICATIONS

Norandex Plus housewrap meets all national code requirements and can be used under all types of siding and masonry cladding materials such as vinyl siding, wood, steel, brick, stone and fiber cement.

- Tiny micro perforations allow moisture vapor inside the wall cavity to escape, and prevents moisture condensation
- Light weight and easy to install
- Tear resistance reduces jobsite waste
- Meets or exceeds all building codes
- Nationwide Distribution

Product Specification		Test
Composition	Woven Polypropylene	
Weight Per Roll	14.4 lbs/MSF	
Thickness	6.5 mils	
Tensile Strength		ASTM D-882
Machine Direction	58	
Cross Direction	44	
Tear Strength		ASTM D-5034
Machine Direction	42	
Cross Direction	38	
Water Resistance	Pass	ASTM D-1709
MVTR/Perms	9 Perms	ASTM E-96
Fire Rating	Class A	ASTM E-94

Roll Size	Rolls per Pallet
9 ft x 100 ft	50
9 ft x 150 ft	45
9 ft x 195 ft	40
10 ft x 100 ft	50
10 ft x 150 ft	45
10 ft x 195 ft	40
3 ft x 150 ft	135

**Norandex Plus Housewrap
can be imprinted with YOUR LOGO!!**

Put your name right in the center of every wall you cover with our FREE custom-imprinting program. Order your personalized house wrap one pallet at a time with no plate charges or additional printing fees. Order will arrive within 14 days of factory receipt of order. *(Customization N/A on 3' x 150')*

Minimum Quantity: One Pallet
 Additional Charge: None
 Plate Charge: None (Up to 500 square inches maximum)
 Select 1 or 2 colors for Logo: Standard colors offered at no additional charge

Standard Imprint Colors

RED PMS 186	GREEN PMS 376	GREEN PMS 382
RED PMS 202	BROWN PMS 464	PURPLE PMS 274
BLUE PMS 280	GRAY PMS 430	BURGUNDY PMS 492
BLUE PMS 287	GREEN PMS 361	BLACK
BLUE PMS 293	ORANGE PMS 151	YELLOW PANTONE C
GREEN PMS 357	ORANGE PMS 172	YELLOW PMS 141
GREEN PMS 342	ORANGE PMS 485	BROWN PMS 4635
		GRAY PMS 425

SEAMING TAPE: Order in case qty (12 tape rolls/case) size: 3" x 110 yards
 Freight prepaid on seaming tape when ordered with a pallet of housewrap



PRODUCT SPECIFICATIONS

Norandex Plus with DRAIN PLANE is a woven and coated polypropylene water resistant barrier, air barrier and drainage plane housewrap. The drain plane comes from an advanced channel built into the fabric which allows for water to drain down the surface of the membrane while still protecting the structure from water and air infiltration. **Norandex Plus with DRAIN PLANE** is the one product answer to all of the protection needed in your current build.

- Incorporated drain plane, air barrier and water resistive barrier built into one membrane
- Light in weight and easy to install
- Excellent tear strength for job site strength
- Meets and exceeds all current building codes
- Custom print available in two colors, with one pallet minimum, at no additional cost
- Nationwide distribution

Product Specifications		Test Method
Weight Per Roll	14.4 lbs/MSF	
Thickness	6.5 mils	
Drainage Results	>98%	ASTM E-2273
Testile Strength MD	58 lbs.	ASTM D-882
CD	44 lbs.	
Air Leakage	<0.02 L/s/m ² @ 75 Pa	ASTM E-2178
Tear Strength MD	42 lbs.	ASTM D-5034
CD	38 lbs.	
Composition	Polypropylene woven/coated	
Water Resistance	Pass	
MVTR/Perms	9 Perms	ASTM E-96
Fire Rating	Class A	ASTM E-94

Roll Size	Rolls/Pallet
9 ft x 100 ft	50
9 ft x 150 ft	45
9 ft x 195 ft	40
54 in x 100 ft	100
54 in x 150 ft	90
54 in x 195 ft	80
36 in x 100 ft	150
36 in x 150 ft	135
36 in x 195 ft	120

X WRAP

Low Perm

PRODUCT SPECIFICATIONS

X Wrap Low Perm is the only choice for demanding applications to protect from severe weather conditions and environments. **X Wrap Low Perm** prevents the infiltration of air and water while still allowing for the escape of water vapor. The most unique feature is the *ALTA 360 degree* drainage that no other wrap in the world can give. The *ALTA 360 degree* drains in EVERY direction, no matter the final wall cladding, wood, vinyl, metal, brick, stone, cement sidings, stucco or EFIS. The incorporation of *ALTA 360 degree* makes **X Wrap Low Perm** a one of a kind all weather protection layer for any type of construction with the assurance of quality and lifelong service.

- Custom print available in two colors, with one pallet minimum, at no additional cost
- Nationwide distribution

Roll Size	Rolls Per Pallet
36" x 100'	50 Rolls
36" x 150'	45 Rolls
54" x 100'	100 Rolls
54" x 150'	90 Rolls
9' x 100'	50 Rolls
9' x 150'	45 Rolls
9' x 195'	40 Rolls
10' x 100'	50 Rolls
10' x 150'	45 Rolls
10' x 195'	40 Rolls

Product Specifications		Test Method
Air Penetration Resistance	0.0013	ASTM E2178 (cfm/ft ² @1.57 psf)
	>2000	Gurley Hill (TAPPI-T460) (sec/100cm)
Water Vapor Transmission	105	ASTM E96 Method A (g/m ² /24 hrs)
	15	(perms)
	72	ASTM E96 Method B (g/m ² /24 hrs)
	10.4	(perms)
Water Penetration Resistance	>300	AATCC 127 (cm)
Basis Weight	2.2	TAPPI T-410 (oz/sq yd)
Thickness	8	ASTM D3776 (mils)
Breaking Strength	30	ASTM D882 (lb/in) MD
	30	ASTM D882 (lb/in) CD
Dry Tensile	45	ASTM D5034 (lb/in) MD
	45	ASTM D5034 (lb/in) CD
Tear Resistance (Trapezoid)	13.5	ASTM D1117 (lbs) MD
	12.5	ASTM D1117 (lbs) CD
Drainage Efficiency	>95%	ASTM E2273
	>95%	ICC-ES AC 235 Section 4.5
Surface Burning Characteristics	5 Class A	ASTM E84 Flame Spread Index
	45 Class A	Smoke Develop Index
Ultra Violet Light Exposure	180 days	

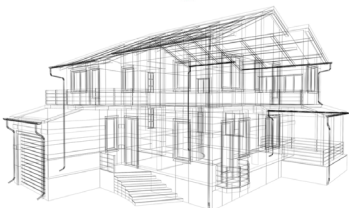

X WRAP

High Perm

PRODUCT SPECIFICATIONS

X Wrap High Perm is the only choice for demanding applications to protect from severe weather conditions and environments. **X Wrap High Perm** prevents the infiltration of air and water while still allowing for the escape of water vapor. The most unique feature is the *ALTA 360 degree* drainage that no other wrap in the world can give. The *ALTA 360 degree* drains in EVERY direction, no matter the final wall cladding, wood, vinyl, metal, brick, stone, cement sidings, stucco or EFIS. The incorporation of *ALTA 360 degree* makes **X Wrap High Perm** a one of a kind all weather protection layer for any type of construction with the assurance of quality and lifelong service.

- Custom print available in two colors, with one pallet minimum, at no additional cost
- Nationwide distribution

Roll Size	Rolls Per Pallet
36" x 100'	50 Rolls
36" x 150'	45 Rolls
54" x 100'	100 Rolls
54" x 150'	90 Rolls
9' x 100'	50 Rolls
9' x 150'	45 Rolls
9' x 195'	40 Rolls
10' x 100'	50 Rolls
10' x 150'	45 Rolls
10' x 195'	40 Rolls

Product Specifications		Test Method
Air Penetration Resistance	0.00082	ASTM E2178 (cfm/ft2@1.57 psf)
	>2500	Gurley Hill (TAPPI-T460) (sec/100cm)
Water Vapor Transmission	385	ASTM E96 Method A (g/m2/24 hrs)
	55	(perms)
	465	ASTM E96 Method B (g/m2/24 hrs)
	67	(perms)
Water Penetration Resistance	>300	AATCC 127 (cm)
Basis Weight	2.2	TAPPI T-410 (oz/sq yd)
Thickness	8	ASTM D3776 (mils)
Breaking Strength	30	ASTM D882 (lb/in) MD
	30	ASTM D882 (lb/in) CD
Dry Tensile	45	ASTM D5034 (lb/in) MD
	45	ASTM D5034 (lb/in) CD
Tear Resistance (Trapezoid)	13.5	ASTM D1117 (lbs) MD
	12.5	ASTM D1117 (lbs) CD
Drainage Efficiency	>95%	ASTM E2273
	>95%	ICC-ES AC 235 Section 4.5
Surface Burning Characteristics	5 Class A	ASTM E84 Flame Spread Index
	45 Class A	Smoke Develop Index
Ultra Violet Light Exposure	180 days	

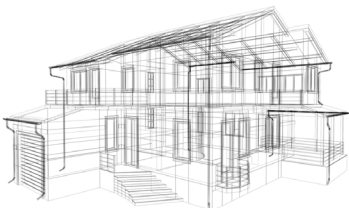

X WRAP Commercial

PRODUCT SPECIFICATIONS

X Wrap Commercial is the only choice for demanding applications to protect from severe weather conditions and environments in multi-family dwellings or commercial buildings that exceed 4 stories. **X Wrap Commercial** prevents the infiltration of air and water while still allowing for the escape of water vapor. The most unique feature is the *ALTA 360 degree* drainage that no other wrap in the world can give. **X Wrap Commercial** can drain in EVERY direction, and gives you the peace of mind to aid in controlling energy cost of the structure. With the use of *ALTA 360 degree X Wrap Commercial* is a one of a kind all weather protection layer for commercial construction with the assurance of quality and lifelong service.

- Custom print available in two colors, with one pallet minimum, at no additional cost
- Nationwide distribution

Roll Size	Rolls Per Pallet
36" x 100'	50 Rolls
36" x 150'	45 Rolls
54" x 100'	100 Rolls
54" x 150'	90 Rolls
9' x 100'	50 Rolls
9' x 150'	45 Rolls
9' x 195'	40 Rolls
10' x 100'	50 Rolls
10' x 150'	45 Rolls
10' x 195'	40 Rolls

Product Specifications		Test Method
Air Penetration Resistance	0.0008	ASTM E2178 (cfm/ft2@1.57 psf)
	>1800	Gurley Hill (TAPPI-T460) (sec/100cm)
	Type 1	ASTM E1677
Water Vapor Transmission	245	ASTM E96 Method A (g/m2/24 hrs)
	35	(perms)
	435	ASTM E96 Method B (g/m2/24 hrs)
	62.6	(perms)
Water Penetration Resistance	>300	AATCC 127 (cm)
Basis Weight	2.3	TAPPI T-410 (oz/sq yd)
Thickness	8	ASTM D3776 (mils)
Breaking Strength	30	ASTM D882 (lb/in) MD
	30	ASTM D882 (lb/in) CD
Dry Tensile	45	ASTM D5034 (lb/in) MD
	45	ASTM D5034 (lb/in) CD
Tear Resistance (Trapezoid)	13.5	ASTM D1117 (lbs) MD
	12.5	ASTM D1117 (lbs) CD
Drainage Efficiency	>95%	ASTM E2273
	>95%	ICC-ES AC 235 Section 4.5
Surface Burning Characteristics	15 Class A	ASTM E84 Flame Spread Index
	45 Class A	Smoke Develop Index
Ultra Violet Light Exposure	180 days	

